

# PIERCE PUBLIC SCHOOL BOND

**BALLOTS DUE:**  
**AUGUST 12TH, 2025**



**PIERCE**  
PUBLIC SCHOOLS

The Pierce Public Schools Board of Education has called a school bond election **in an amount of \$25,995,000** for the purpose of constructing additions and renovations and other site improvements to the existing elementary and high school buildings.

## 1 Safe, Secure, & Modern Facilities

Outdated intercom systems, lack of storm shelters, unsecured entrances compromise student safety and emergency preparedness.

## 2 Space for Growth & Privacy

Overcrowded classrooms, shared gym/cafeteria spaces, and insufficient rooms for special education and mental health services limit learning potential and privacy for those who need it most.

## 3 Improved Learning Environments

Modernized spaces with proper heating, cooling, and technology support uninterrupted, comfortable learning. Upgrades will support current educational programs and prepare students for future careers, including trade and ag-based jobs.

## 4 Expanded Opportunities in Arts & Athletics

Students in theatre, band, and art deserve updated performance spaces, just as athletes need adequate gyms, weight rooms, and facilities for growing programs like girls' wrestling.

## 5 Better Community Access & Economic Impact

New and improved facilities will attract events, tournaments, and community use—bringing pride and economic benefit to our town.

## 6 Efficient Use of Resources

Instead of pouring money into outdated, non-code-compliant buildings like the current auditorium, the plan provides smart, sustainable solutions for long-term success.

### AGRICULTURAL LAND TAX IMPACT OF A 13.9 CENT LEVY

PIERCE COUNTY (LB2 Value Per Acre)	ANNUAL INCREASE PER ACRE	WAYNE COUNTY (LB2 Value Per Acre)	ANNUAL INCREASE PER ACRE
Irrigated 1A1 (\$5,697)	\$7.92	Irrigated 1A1 (\$6,079)	\$8.45
Dry 1D1 (\$3,968)	\$5.52	Dry 1D1 (\$5,347)	\$7.43
Grass 1G1 (\$1,605)	\$2.23	Grass 1G1 (\$1,979)	\$2.75

### RESIDENTIAL PROPERTY TAX IMPACT OF A 13.9 CENT LEVY

VALUATION	ANNUALLY	MONTHLY	DAILY
\$75,000	\$104.25	\$8.69	\$0.29
\$100,000	\$139.00	\$11.58	\$0.38
\$184,355	\$256.25	\$21.35	\$0.70
\$250,000	\$347.50	\$28.96	\$0.95

The average assessed value of a home in Pierce County is \$184,355

### COMMUNITY MEETINGS

**Tuesday, July 8<sup>th</sup>**

**6:30PM @ Auditorium**

**Sunday, July 13<sup>th</sup>**

**6:30PM @ Elementary School Gym**

**Monday, July 21<sup>st</sup>**

**6:30PM @ High School Multipurpose Room**



Scan QR code or visit  
**pierceschoolbond.com**  
to learn more

ADDITION

RENOVATION

# High School Plan Main Level

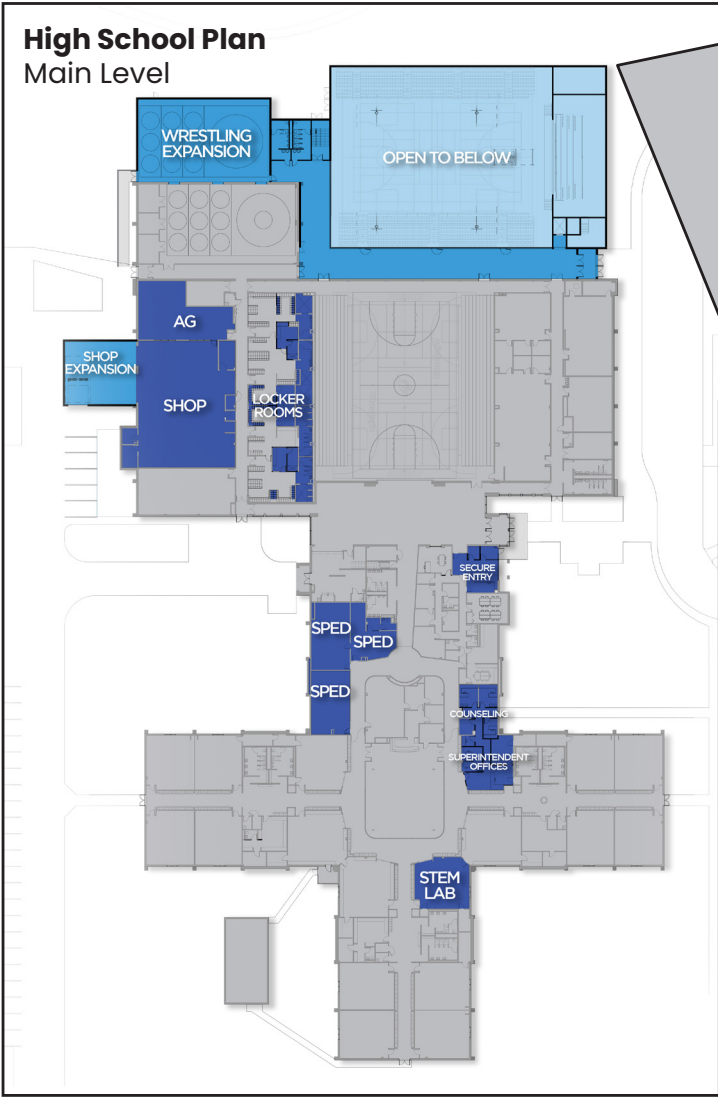

# High School Plan Lower Level

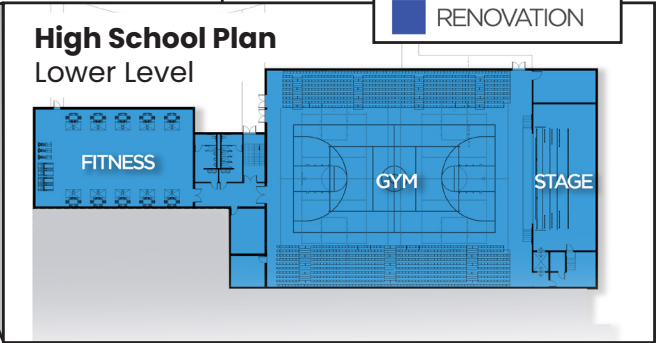

# Elementary School Plan

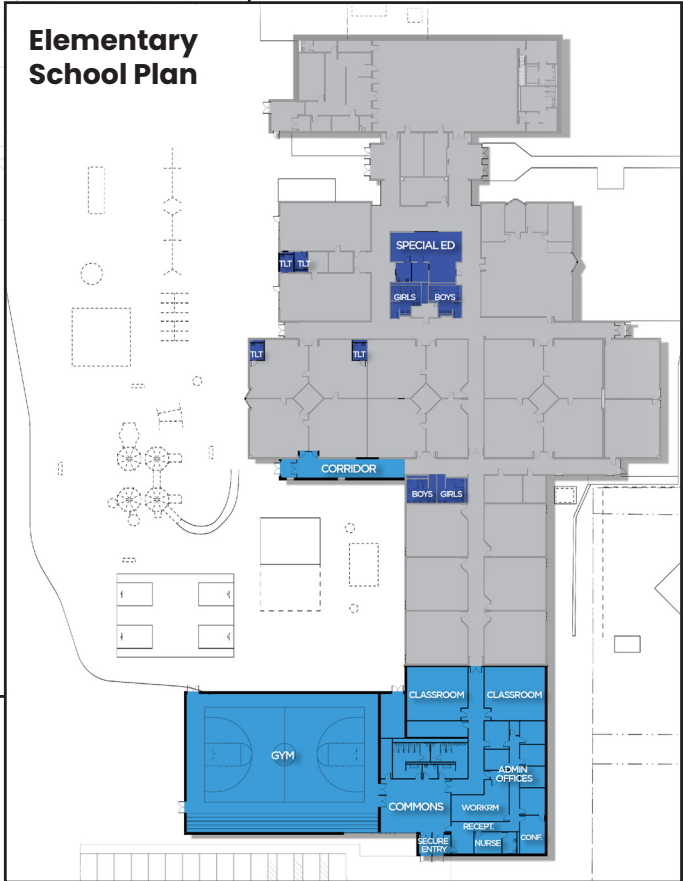

## TRY OUT OUR VIRTUAL REALITY ENVIRONMENTS!

STEP 01  
OPEN THE  
CAMERA APP  
ON YOUR PHONE



STEP 02  
TAP ON THE  
QR WEB LINK



STEP 03  
LOOK AROUND!



ALL IMAGES ARE CONCEPTUAL  
IN NATURE & SUBJECT TO CHANGE



Elementary Main Entrance



Elementary Commons & Secure Entry



Elementary Classroom



High School Shop



High School Gym & Stage



High School Fitness